



Suitable for small size cases this erector seals cases with self adhesive tape (Type 247) or hot melt glue (Type 248). The added benefit of this machine is the inclusion of a servo drive to increase speeds.

Features of the 247/248 include:

Servo Driven



While allowing the machine to reach higher speeds - up to 25 cases per minute - the servo drive system permits greater flexibility and control by allowing almost instant acceleration and deceleration of cases through the erecting process. In turn this system can save energy because the servo drives only use power when needed.

Dual Opposing Vacuum Case Opening



This unique design feature ensures that each case is opened positively from both sides. It ensures the efficient and reliable opening of cases, and overcomes problems that can be associated with stiff board and glue migration from the manufacturer's joint.

Clear Access



Simple mechanical operation and clear access for easy size change, cleaning and maintenance.

Low Cost of Ownership



The Endoline 247 & 248 Case Erectors are designed to give you the best possible value for your investment. Our unique set of features and benefits means you will gain the maximum productivity with minimal stoppage time for problem-solving or case size changes.

Easy to Use



The 247 & 248 are designed with clear access, simple controls and quick to adjust to size changes. The machines are operator friendly and allow for quick and easy size change, cleaning and maintenance to ensure minimal machine downtime.

Robust Construction



Built with high quality components and housed in a robustly designed chassis, the 247 & 248 are robust enough to withstand the rigours of typical 24-hour end-of-line packaging environments.



247 & 248

Fully Automatic Servo Driven Case Erectors

OPTIONS INCLUDE:

- Low hopper sensing
- Low tape and no tape sensing
- Low glue sensing
- Visual audible failure alarm

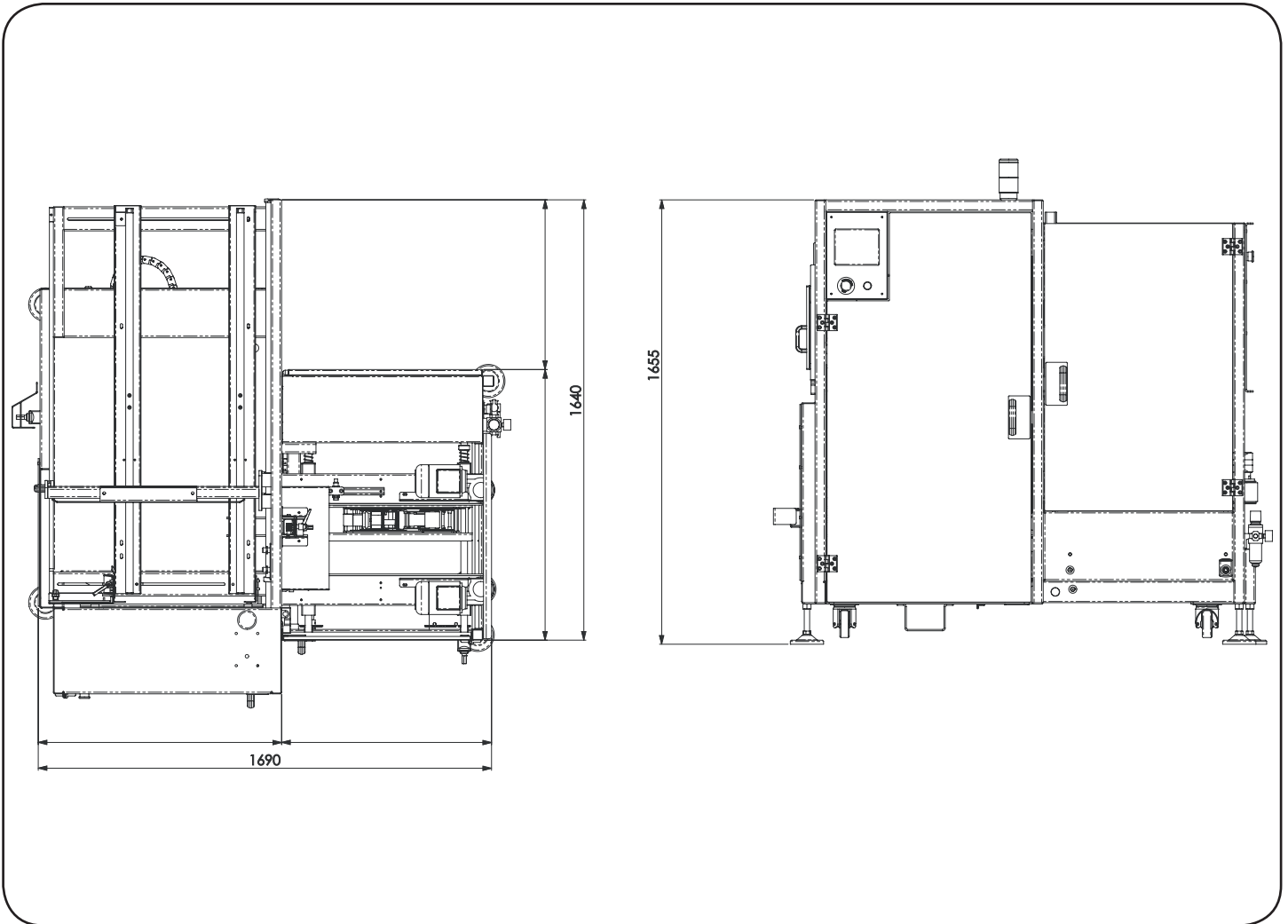

Case Dimensions (mm).

	Length	Width	Height (open)
247/248 Minimum	160	100	150
Maximum	400	300	400

Speed

Up to 25 cases per minute

Pneumatics

200 litres/min
(5.5 bar) (19.5 litres/cycle)

Electrical Supply

Type 247 Three phase:
380 - 415V, 50Hzvv

Type 248 Three phase:
380 - 415V, 50Hz

Tape Size (Type 247)

Standard: up to 50mm wide

Machine Finish

Mild steel, powder coated white
(RAL 9010) or stainless steel

© Endoline reserves the right to change specifications without prior notice.



Endoline Machinery Limited
Stratton Business Park, London Road
Biggleswade, Bedfordshire
SG18 8QB
United Kingdom

Telephone: +44 (0) 1767 316422
Facsimile: +44 (0) 1767 318033
E-mail: sales@endoline.co.uk
Website: www.endoline.co.uk